



# MEETING LOGIN

Trouble logging into the meeting?  
First, check the TIME...

1 HOUR

Sign-in opens one hour before the meeting start time.

You will not be able to log in earlier than one hour before the meeting starts.

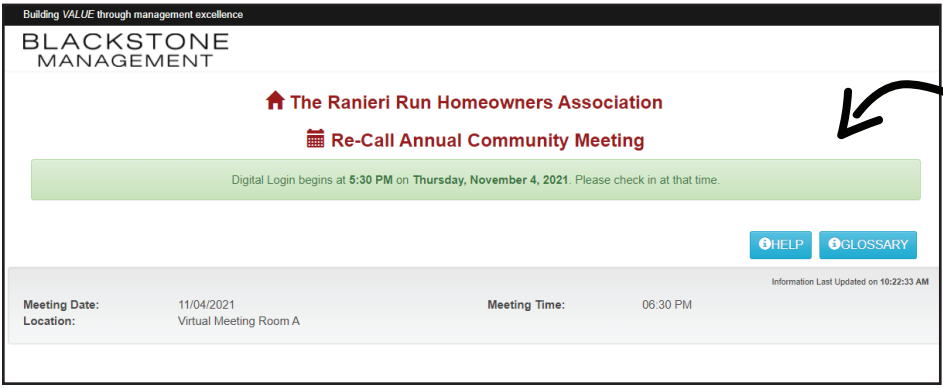

This green bar will display the login time for your meeting.

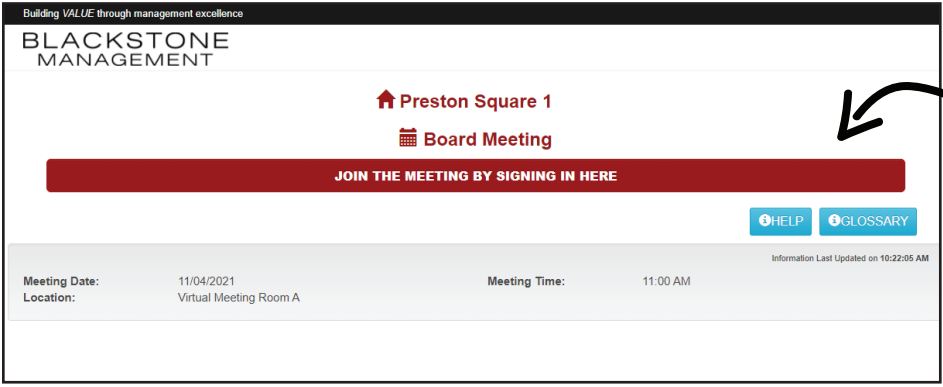

One hour before your meeting, this bar will be red. Now you can click the red bar to login.

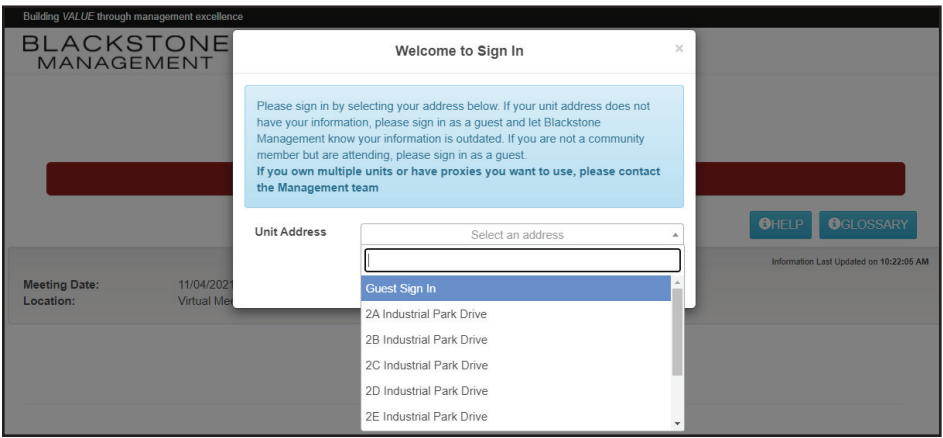

Select your address from the drop-down list.

If you are not a community member, but are attending the meeting, please sign in as a guest.

*\*NOTE: If you are signed in as a guest, you will not have voting permissions*

Next steps to completing your Login...

# MEETING LOGIN FINAL STEPS

## IS YOUR CONTACT INFO CURRENT?

If not, visit [www.BlackstoneAM.com/info](http://www.BlackstoneAM.com/info)

As mentioned in our meeting notice, your current contact information is required in order to login and participate in meetings.

If you see an outdated phone number or email address here, you will need to log in as a guest for this meeting.

Contact updates must be made at least 24 hours prior to the meeting

After you verify your contact information, click the SEND CODE button. You will receive a code via email AND text message to verify your identity. Both codes will be the same number.

**SEND CODE**

Welcome to Sign In

Please sign in by selecting your address below. If your unit address does not have your information, please sign in as a guest and let Blackstone Management know your information is outdated. If you are not a community member but are attending, please sign in as a guest. If you own multiple units or have proxies you want to use, please contact the Management team

Unit Address

To verify your identity, we will send you a code via email AND text. The codes sent will be the same. Please input after receipt.

Rogers, Steven **SEND CODE**

your phone number  your email address

N/A **SEND CODE**

No Phone for Owner No Email for Owner

**Texted Code**

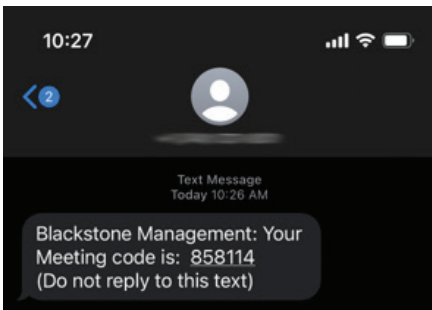

**Emailed Code**



*(Both code numbers will be the same)*

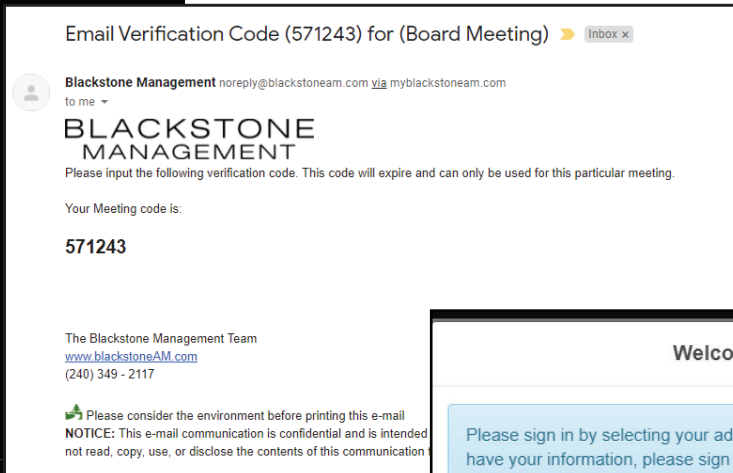

Enter the code that was sent by text and email to you

**HERE**

**Click** **VERIFY**

Meeting Login is Complete!

Welcome to Sign In

Please sign in by selecting your address below. If your unit address does not have your information, please sign in as a guest and let Blackstone Management know your information is outdated. If you are not a community member but are attending, please sign in as a guest. If you own multiple units or have proxies you want to use, please contact the Management team

Unit Address

Input the Verification code that was sent to you.

**VERIFY**

Did not receive the code? Click back to resend.

**BACK**

